

HD500 Series HURRICANE RESISTANT

This durable 2-1/2" x 5" , center-set screw spline system is designed for a 1-5/16" and 9/16" glazing, up to a 10'-0' tall span that is certified by the Miami Dade County and Texas Department of Insurance (TDI) Product Evaluations.

Easy to install and help complete those complex projects due to the reduced components that allows flexibility while holding up to category 4 wind zone.

It is also available with a mechanical lock using our Lanced Thermal Break . The Lancer not only enhances its strength but also helps reduce energy transferred through the thermal barrier.

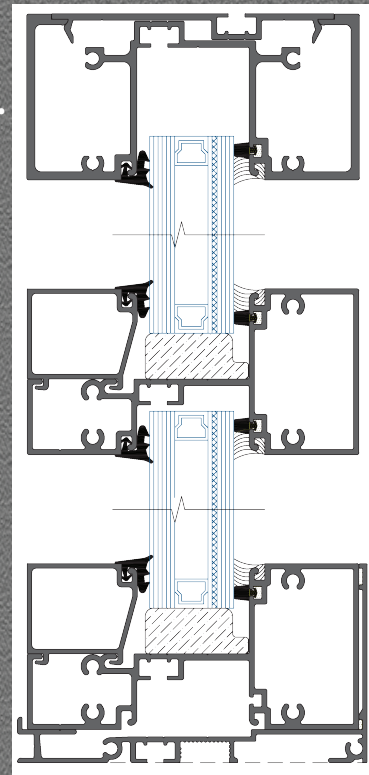

TOUGHNESS APPROVED

ASTM E 330-14

ASTM E 1886-19

ASTM E 1996-17

CATEGORY 4 PROTECTION

LARGE MISSILE IMPACT TESTED - LEVEL D

CERTIFIED FOR MIAMI DADE COUNTY AND T.D.I.

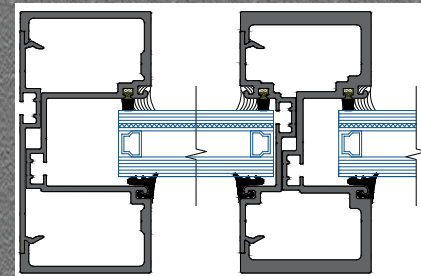
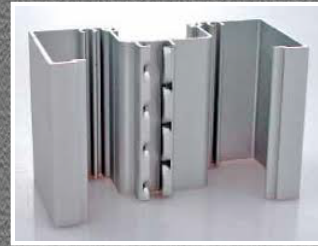

EFFICIENT PRODUCT

EASIER INSTALLATIONS WITH LESS COMPONENTS.

SAVE TIME AND MONEY WITH SIMPLIFIED ANCHORING. WET AND

DRY GLAZE OPTIONS FOR 1-5/16" AND 9/16". THERMAL OPTION

TO HELP REDUCE THE AMOUNT OF HEAT OR COLD TRANSFERRED

THROUGH THE FRAMES.

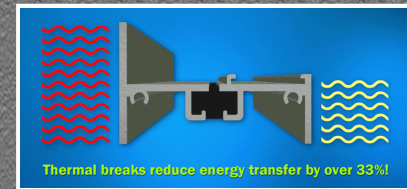

OVER 20 YEARS EXPERIENCE IN THE INDUSTRY

Our knowledgeable sales staff and manufacturing team have the experience needed to help you analyze your needs from start to finish, with quality being our number one priority. With the quickest lead time in the industry, Atlas Architectural Metals is using state of the art machinery for all types of fabricating.

All of our Custom doors, frames and our in stock products have precision cuts to specifications.

STOREFRONT • HURRICANE RESISTANT • CURTAINWALL

ENTRANCES • MALL SLIDERS • DRYWALL



11940 Brittmoore Park DR. Houston, TX 77041

P:713-869-9551 F:713-869-4254

www.atlasarchmetals.com



Certificate No. 7980

